

Standard Flipper Valve

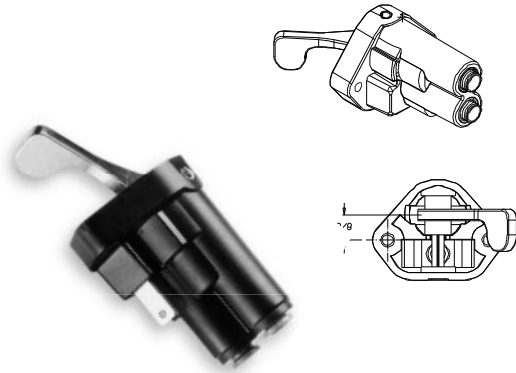

The GT 3222 flipper valves are heavy-duty valves and push-to-connect fittings. These three-way valves are designed for the dashboard operation of truck air system accessories.

Performance

Application	Three-way valve designed for dashboard operation of truck air system accessories.
Material	DuPont Minlon® 10B40 BK061, 40% Mineral Reinforced Nylon 66, DAM.
Function	When valve is switched off (flipper to right position), supply is blocked and delivery is vented. When valve is switched on, supply is connected to delivery.
GTD Part Number	3222-1
Rated PSI	150 PSIG maximum
Operating Temperature	-10° F (-23.3° C) to 160° F (71.1° C)
Allowed Leakage:	On and off leakage 30 SCCM at 120 PSIG.
Equivalent Orifice	¼" fittings, assuming Cd= .65 Inlet to outlet = .120 diameter or greater Outlet to exhaust = .080 diameter or greater
Connectors	Two ¼" push-to-connect fittings with rigid tube support ¼" push-to-connect fittings meeting DOT FMVSS 106 50 lb. pull test when used with SAE J844 nylon tubing.
Weight	61 grams (approximate)
Packaging	Bulk

Standard Flipper Valve



Drawings

