

Toggle-Style Air/Electric Switch

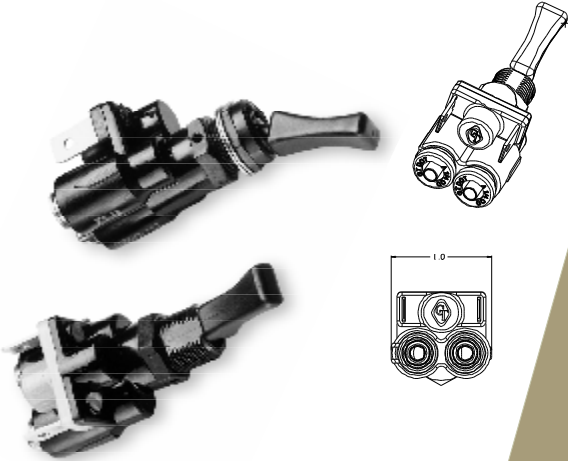

The GT series of 3200 and 3201 air/electric switches are compact, multi-purpose valves with push-to-connect air fittings and a variety of hardware and toggle options. These three-way valves are designed for the dashboard operation of truck air system accessories.

Performance

Application	Three-way valve combined with integral pressure switch (normally open or normally closed) designed for dashboard operation of truck air system accessories.
Material	Zytel, nylon glassed filled.
Function	(A) When valve is switched off, supply is blocked and delivery is vented. When valve is switched on, supply is connected to delivery. (B) With the valve in the "on" position, (P/N 3200-NO) and pressure measured at the outlet port with supply air to the inlet port, the switch shall close the contacts with a maximum pressure of 50 PSIG, and open the contacts with a minimum pressure of 10 PSIG. With the valve in the "on" position (P/N 3201-NC) and pressure measured at the outlet port with supply air to the inlet port, the switch shall open the contacts with a maximum pressure of 50 PSIG, and close the contacts with a minimum pressure of 10 PSIG.
GTD Part Number	3200-XX (normally open electric) 3201-XX (normally closed electric)
Rated PSI	150 PSIG maximum
Operating Temperature	-10° F (-23.3° C) to 160° F (71.1° C)
Allowed Leakage:	30 SCCM with 120 PSIG applied to the inlet port, with the outlet port blocked, In either the "on" or "off" positions.
Equivalent Orifice	¼" fittings, assuming Cd= .65 Inlet to outlet = .120 diameter or greater Outlet to exhaust = .080 diameter or greater

Toggle-Style Air/Electric Switch

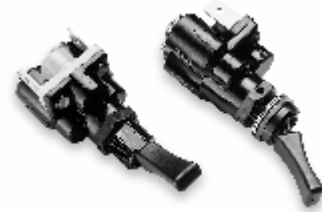

Performance

Connectors	Two ¼" push-to-connect fittings with rigid tube support. Fittings meet DOT FMVSS 106 50 lb. pull test when used with SAE J844 nylon tubing. Two ¼" blade type electrical terminals meet SAE J858A-1B standards.
Weight	25 grams (approximate)
Packaging	Bulk

Drawings

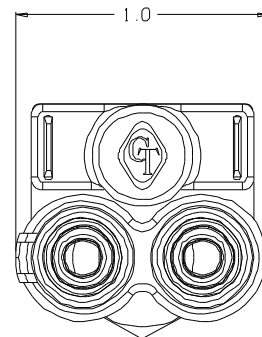
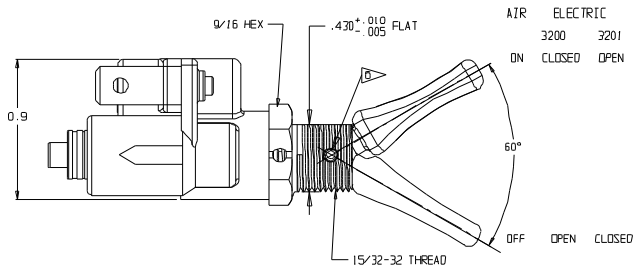
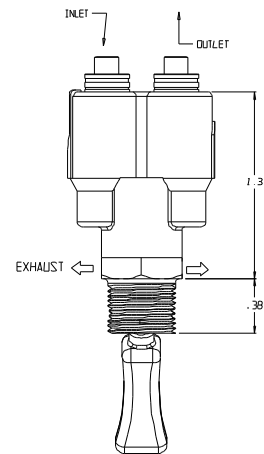
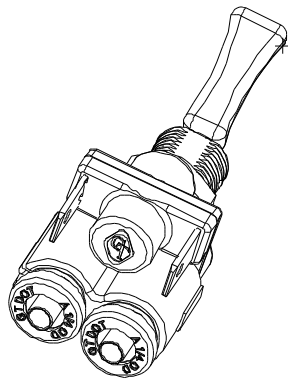

Toggle-Style Air/Electric Switch

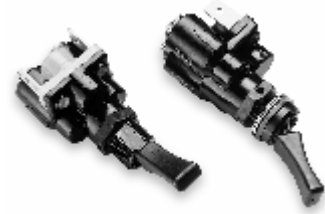

Additional Mounting Hardware and Toggle Types

OPTIONAL TOGGLES

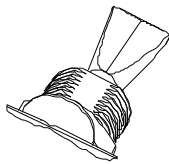

-2

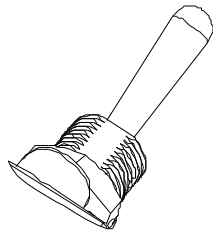

-3

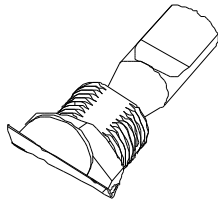

-4

OPTIONAL HARDWARE

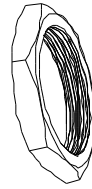

A

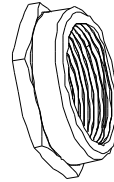

B

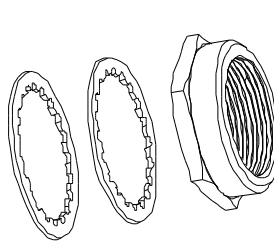

C

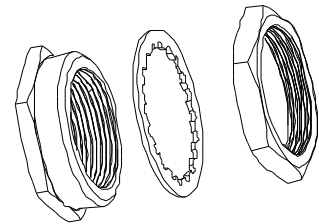

E