

## Air/Electric Flipper Valve

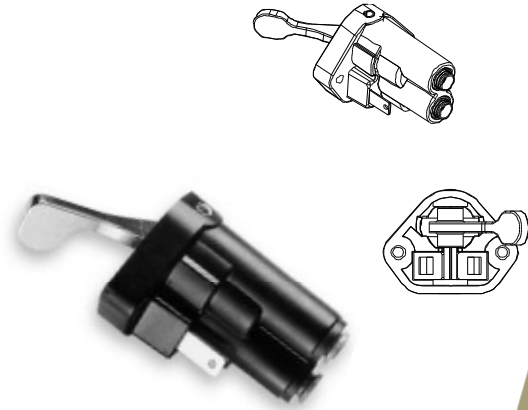

The GT 3223 Air/Electric flipper valves are heavy-duty valves with integral pressure switches (normally open or normally closed), and push-to-connect air and electrical fittings. These three-way valves are designed for the dashboard operation of truck air system accessories.

### Performance

Application	Three-way valve designed for dashboard operation of truck air system accessories.
Material	DuPont Minlon® 10B40 BK061, 40% Mineral Reinforced Nylon 66, DAM.
Function	<p>(3223-1) When valve is switched off (flipper to right position), supply is blocked and delivery is vented. When valve is switched on, supply is connected to delivery. (Normally open pressure switch, flipper right side off. Pressure switch senses outlet pressure, switch is open below 10 PSIG and closed above 35 PSIG.</p> <p>(3223-2) When valve is switched off (flapper to left position) supply is blocked and delivery is vented. When valve is switched on, supply is connected to delivery. Pressure switch senses outlet pressure, switch is closed below 10 PSIG and open above 35 PSIG. Normally closed pressure switch, flipper right side on.</p>
GTD Part Number	3223-1 (normally open electric) 3223-3 (normally closed electric).
Rated PSI	150 PSIG maximum
Rated Current Load	The electric switching is designed for a maximum of 5 Amp resistive current load at 12 volts.
Operating Temperature	-10°F (-23.3°C) to 160°F (71.1°C)
Allowed Leakage:	30 SCCM with 120 PSIG applied to the inlet port, with the outlet port blocked, in either the "on" or "off" position.
Equivalent Orifice	<p>¼" fittings, assuming Cd= .65</p> <p>Inlet to outlet = .120 diameter or greater</p> <p>Outlet to exhaust = .080 diameter or greater</p>

## Air/Electric Flipper Valve



### Performance

Connectors	Two 1/4" push-to-connect fittings with rigid tube support. Fittings meeting DOT FMVSS 106 50 lb. pull test when used with SAE J844 nylon tubing. Two 1/4" blade type electrical terminals meeting SAE J858A-1B standards.
Weight	61 grams (approximate)
Packaging	Bulk

### Drawings

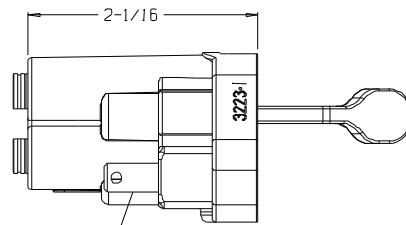
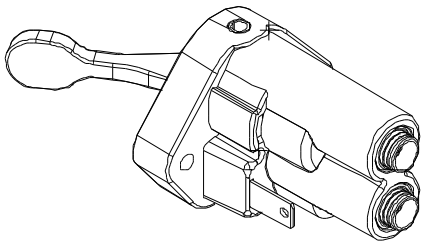

1/4" BLADE TYPE  
TERMINAL TYP 2 PL

